

# HSF

**NOTES:**

Voltage Rating: 50V AC/DC  
 Current Rating: 0.5AMP  
 Contact Resistance: 20mΩ max  
 Withstand Voltage: 500V AC/Minute  
 Insulation Resistance: 500MΩ min  
 Operation Temperature: -40°C to +105°C

Contact Material: Phosphor Bronze  
 Contact Plating: Sn OR Au OVER Nickel  
 Insulator Material: PA9T+33%GF UL94V-O BLACK

## Ordering Information

3651-S XXX - 042 XX R0X

| No. of Pins | Plating           | Packing     |
|-------------|-------------------|-------------|
| 006: 06 Pin | G0=Gold Flash     | R=Tape&Reel |
| 010: 10 Pin | G3=10u"Gold       |             |
| 012: 12 Pin | G4=15u"Gold       |             |
| 014: 14 Pin | G5=30u"Gold       |             |
| 016: 16 Pin | S0=Gold Flash/Tin |             |
| 018: 18 Pin | S3=10u"Gold/Tin   |             |
| 020: 20 Pin | S4=15u"Gold/Tin   |             |
| 022: 22 Pin | S5=30u"Gold/Tin   |             |
| 024: 24 Pin | SN=Tin            |             |

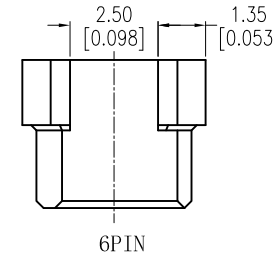
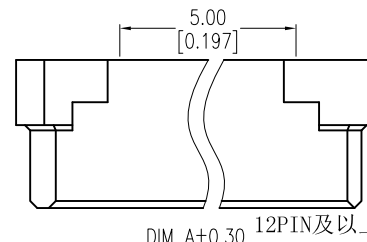
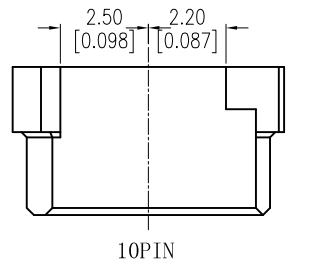

Recommended P.C.B Layout (Top Side)  
 (PCB BOARD TOLERANCE ±0.05)

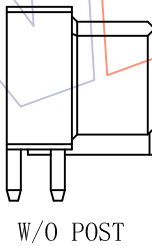
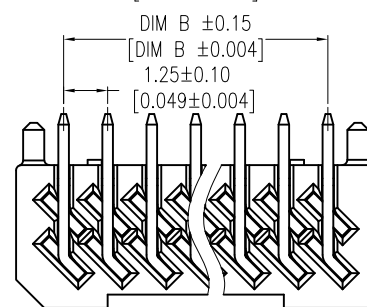
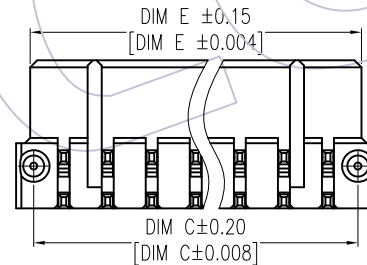
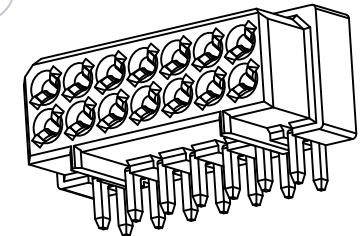
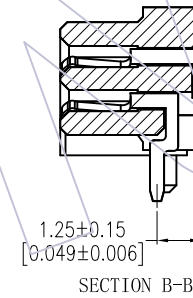
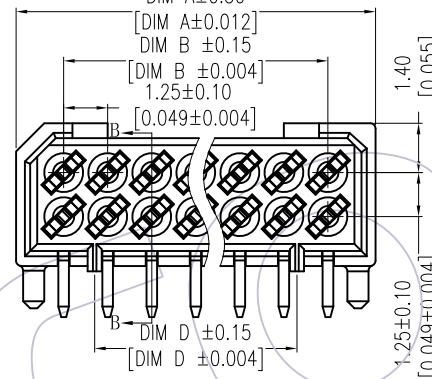
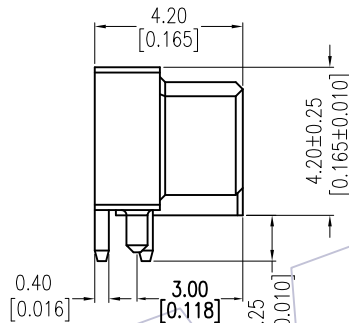
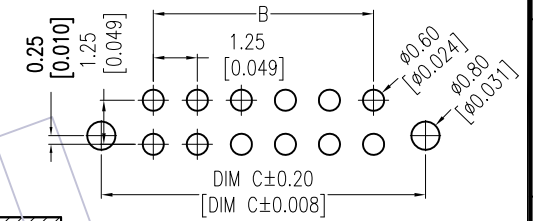

|                    |          |
|--------------------|----------|
| 3651-SXXX-042XXR04 | W/O POST |
| 3651-SXXX-042XXR03 | W/T POST |

|       |       |       |       |       |      |
|-------|-------|-------|-------|-------|------|
| 15.65 | 11.99 | 15.45 | 13.75 | 16.45 | 24   |
| 14.40 | 10.74 | 14.20 | 12.50 | 15.20 | 22   |
| 13.15 | 9.49  | 12.95 | 11.25 | 13.95 | 20   |
| 11.90 | 8.24  | 11.70 | 10.00 | 12.70 | 18   |
| 10.65 | 6.99  | 10.45 | 8.75  | 11.45 | 16   |
| 9.40  | 5.74  | 9.20  | 7.50  | 10.20 | 14   |
| 8.15  | 4.49  | 7.95  | 6.25  | 8.95  | 12   |
| 6.90  | 3.24  | 6.70  | 5.00  | 7.70  | 10   |
| 4.40  | 0.74  | 4.20  | 2.50  | 5.20  | 6    |
| E     | D     | DIM C | B     | A     | Pos. |

| REV | DATE       | MODIFICATION DESCRIPTION | CHANGE | OPERATION |       | DRAW       | DATE       | SCALE | FIT | PART NO.                        |
|-----|------------|--------------------------|--------|-----------|-------|------------|------------|-------|-----|---------------------------------|
|     |            |                          |        | X.X       | ±0.40 |            |            |       |     |                                 |
|     |            |                          |        | X.XX      | ±0.25 | DingWenMin | 2016.10.20 | UNIT  | mm  | 3651-SXXX-042XXR0X              |
|     |            |                          |        | X.XXX     | ±0.15 | CHECK      | DATE       | SIZE  | A4  | TITLE:                          |
| A0  | 2016.10.20 | NEW                      | ----   | Angle     | ± 3'  | APPROVE    | DATE       | SHEET | 1/1 | 1.25mm BTB FEMALE, 90° DIP TYPE |
|     |            |                          |        | DIM       | TOL   |            |            | PROJ. | ⌀   | Customer NO.                    |

**WCON**  
 Http: www.wcon.com

WCON-Dongguan  
 Tel: +86 769 85358920  
 Fax: +86 769 85358915  
 E-mail: sales@wcon.com

WCON-Kunshan  
 Tel: +86 512 57468408  
 Fax: +86 512 57468468  
 E-mail: sales@wcon.com