

HSF

NOTES:

Rated Current: 5.0A
 Contact Resistance: 20mΩ max
 Withstand Voltage: 1500V AC/Minute
 Insulation Resistance: 1000MΩ min
 Operation Temperature: -25°C to +105°C
 Insulator Material: PA66 UL94V-0
 Use with: WF3001-MT (Mole Contact)

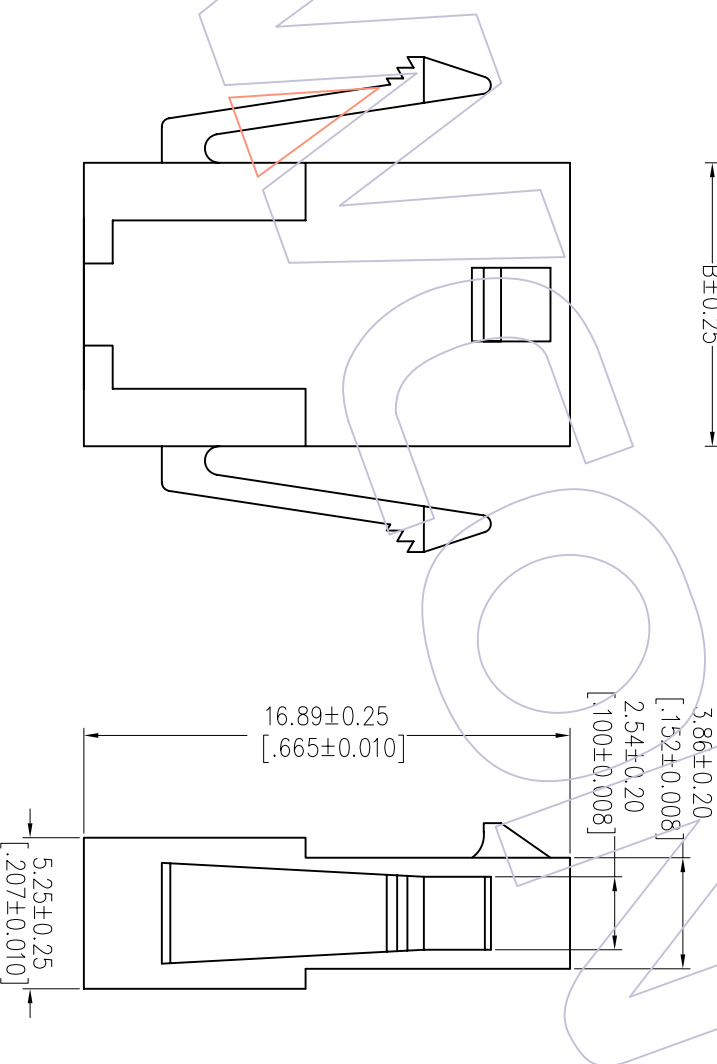
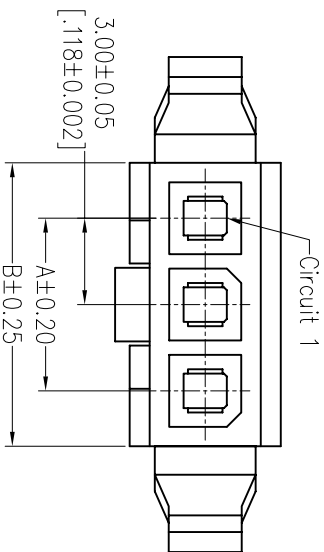

Ordering Information

WF 3001 - 1HK XX B 01

No. of rows
Single Row

No. of pins
02~12pin

Color
E=Beige
W=White
B=Black

Packing
0=PE Bag

Circuit	Part No.	Dimension	
		A	B
02	WF 3001-1HK02B01	3.00	6.85
03	WF 3001-1HK03B01	6.00	9.85
04	WF 3001-1HK04B01	9.00	12.85
05	WF 3001-1HK05B01	12.00	15.85
06	WF 3001-1HK06B01	15.00	18.85
07	WF 3001-1HK07B01	18.00	21.85
08	WF 3001-1HK08B01	21.00	24.85
09	WF 3001-1HK09B01	24.00	27.85
10	WF 3001-1HK10B01	27.00	30.85
11	WF 3001-1HK11B01	30.00	33.85
12	WF 3001-1HK12B01	33.00	36.85

OPERATION	XX	±0.40	DRAW	JYHuang	DATE	2012/09/20	SCALE	UNIT	mm	FIT	1/1
CHECK	XXX	±0.25	CHECK		DATE		SIZE	A4			
Angle	XXX	±0.15	APPROVE		DATE		SHEET	1/1	PROJ.		
TOL		± 3'									

PART NO. SEE TAB

TITLE: 3.00mm SINGLE ROW HOUSING

CUSTOMER NO.

WCON

Http: www.wcon.com

WCON-Dongguan
 Tel: +86 769 85358920
 Fax: +86 769 85359915
 E-mail: sales@wcon.com

WCON-Kunshan
 Tel: +86 512 57468408
 Fax: +86 512 57468468
 E-mail: sales@wcon.com

REV	DATE	MODIFICATION DESCRIPTION	CHANGE
AO	2012/09/20	NEW	